

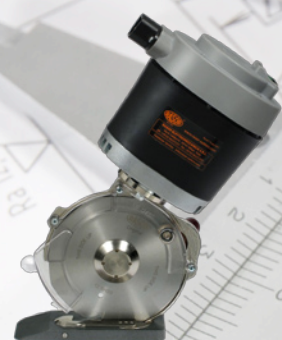

100% MADE IN ITALY

2014
SERIES



AVAILABLE IN
RIGHT VERSION
SW12S



RASOR
all line
RASOR ELETTROMECCANICA S.R.L.
Via V. Caldesi 6 - 20161 Milan - Italy
ph. +39 02 66221231 - fax +39 02 66221293
Customer Service: info@rasor-cutters.com



RASOR®

1946

SW12SSX ELECTRIC CUTTING UNIT

SW12SSX. Professional cutting unit for Textile & Technical Textile applications.



1946

ELECTRIC CUTTING UNIT SW12SSX



WHAT'S NEW:

New main power switch with Led
Easy fixing structure for O.E.M applications
Low-friction Teflon® coated foot

Dimension layout

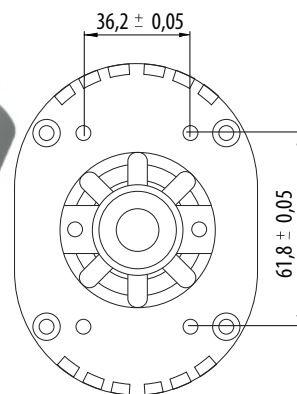
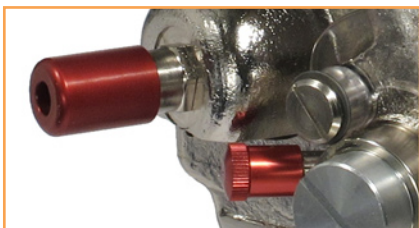
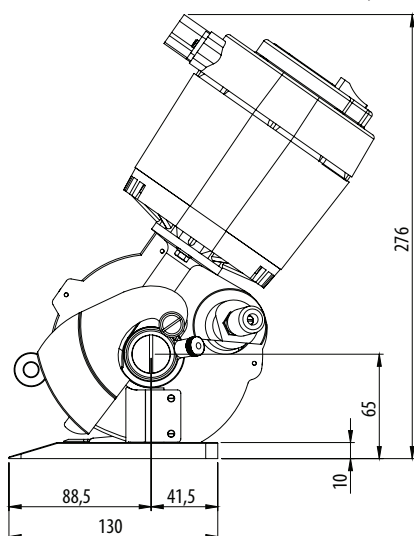

Fixing layout

TECHNICAL DETAILS:

Blade diameter: 120 mm (4.7"), with hard metal counterblade

Blade equipped: 12SHSS, 8-edges, HSS steel

Blade speed: 850 r.p.m.

Cutting ability: up to 50 mm (2")

Power: single phase – 180 W

Max. absorption: 2.5 A

Net weight: 3000 g (with power supply cord)

Total weight (with packing box): 4700 g

Electric cable length: 1.5 mt (with no plug)

Minimum brightness for working operations: LUX 200

Vibrations at start up: < 2.5 m/sec²

Temperature range: 0 – 55 °C

Umidity range: 10 – 95% without condensate

BLADES AVAILABLE:

12SHSS, 120 mm 8-edges, HSS steel | **12CSW**, 120 mm circular, EXTRA steel | **12DHSS**, 120 mm 12-edges, HSS steel | **12SHSSTF**, 120 mm 8-edges, HSS steel Teflon® coated | **12SHSSTN**, 120 mm 8-edges, HSS steel Titanium coated | **12DHSSTN**, 120 mm 12-edges, HSS steel Titanium coated | **12SMD**, 120 mm 8-edges, Carbide (Widia®)



FOLLOW US:



RASOR ELETTROMECCANICA SRL

Via Vincenzo Caldesi 6

20161 Milan · Italy

ph. +39 02 66 22 12 31

fax +39 02 66 22 12 93

info@rasor-cutters.com

www.rasor-cutters.com